

Wall Sleeves

Why use Wall Sleeves

Protect your investment using APS wall sleeves to provide a better seal than a core drilled hole. In the absence of wall sleeves, mechanical/utility piping vibration can cause costly damage. In addition, wall sleeves make it easier to repair piping without damaging the wall.

APS offers three types of wall sleeves designed to mate with the Innerlynx® for leak free performance.

All standard sizes of pipe-to-hole or pipe-to-sleeve combinations are shown in the charts on pages 4, 5 & 6. However, there are many other combinations which will also work. To calculate other types of pipe not listed in the standard size charts, refer to the non-standard size formula on page 7.

Each model is available with a 2" water stop that anchors the sleeve to prevent thrust movement and ensure positive water sealing. APS standard water stops are centered, unless otherwise specified.

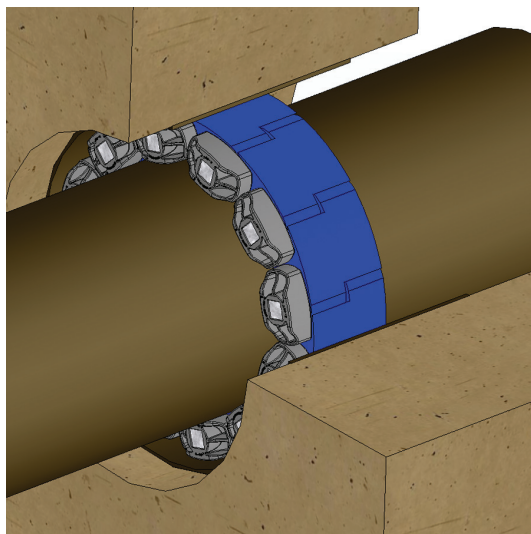

Infinity® Wall Sleeves		
Model	I.D. (in.)	Lbs.
IS-2	1.95	0.70
IS-3	2.89	1.30
IS-3.5	3.36	1.50
IS-4	3.97	2.00
IS-5	5.11	2.80
IS-6	6.11	3.60
IS-8	8.12	4.80
IS-10	10.09	6.40
IS-12	12.07	7.02
IS-14	13.93	11.20
IS-16	16.05	12.00
IS-18	17.22	15.50
IS-20	18.92	17.50
IS-22	20.13	21.00
IS-24	22.56	22.00
IS-25	24.75	23.00

Infinity® Wall Sleeve Features

High Density Polyethylene (HDPE)

- Excellent resistance to acids, alkalis and other organic solvents
- Positive hydrostatic seal
- 16 sizes - 2" to 25"
- Lighter than steel
- Resists water migration
- Adjust to wall thickness
- Locator caps make installation easier



Steel Wall Sleeves	
Nominal Size	Sleeve I.D.
2	2.07
2½	2.47
3	3.07
3½	3.55
4	4.03
5	5.05
6	6.07
8	7.98
10	10.02
12	12.00
14	13.25
16	15.25
18	17.25
20	19.25
22	21.25
24	23.25
26	25.25
28	27.25
30	29.25
32	31.25
34	33.25
36	35.25
38	37.25
40	39.25
42	41.25
48	47.25

Steel Wall Sleeve Features

MODEL: SWSW made of steel with a welded steel water stop.

- More durable than plastic
- Ensures positive water sealing
- Repair piping without damaging wall
- Lifetime leak proof performance
- Available in 2" to 120" diameter

* Available in galvanized also

Gal-Vo-Plast® Wall Sleeve Features

MODEL: GPWSW are made of steel with a welded steel water stop with Gal-vo-plast coating.

- Less expensive than galvanized
- More corrosion resistant
- Faster availability, especially for custom wall sleeves
- Longer installation life
- All coating performed in house
- Considerably more economical
- Available in 2" to 120" diameter

